

Value Plastics

# BIOPROCESSING

Components

**Nordson**  
MEDICAL

# Nordson MEDICAL

## BioProcessing Fittings

<b>Material Reference</b> .....	<b>2</b>
<b>Introduction</b> .....	<b>3</b>
RQ Series Quick Connects .....	4-5
PharmaLok™ Clamps.....	6-9
BioClamp® .....	10
BioValve®.....	11
Sanitary Fittings - Mini Flange .....	12
Sanitary Fittings - Maxi Flange.....	13
Sanitary Fittings - Instrument Tees.....	14-15
Gaskets.....	16-17
Bag Ports.....	18-19
Opposing Barb Ports .....	20-21
Tube-to-Tube Fittings .....	22-31
Luer Fittings .....	32-33
Needlefree Swabable Valves.....	34-35
Check Valves .....	36-39
Stopcocks.....	40-41
Tubing .....	42-43
<b>Index</b> .....	<b>44-47</b>

## Material Reference

<b>-0</b> .....	Natural Nylon	<b>-9002</b> .....	Radiation Stable Polycarbonate
<b>-001</b> .....	Various, see part description	<b>-9024</b> .....	Polycarbonate
<b>-06</b> .....	Orange Nylon	<b>-CM056</b> .....	RENOLIT SOLMED Granuflex 4301 Polyethylene
<b>-07</b> .....	Yellow Nylon	<b>-E</b> .....	PTEE/EPDM
<b>-1</b> .....	White Nylon	<b>-J1A</b> .....	Natural Kynar® PVDF
<b>-2</b> .....	Black Nylon	<b>-J1A2</b> .....	Natural Kynar® PVDF
<b>-3</b> .....	Red Nylon	<b>-PX</b> .....	Platinum-Cured Silicone
<b>-4</b> .....	Green Nylon	<b>-U706</b> .....	Orange Class VI Glass Filled Nylon
<b>-5</b> .....	Blue Nylon	<b>-U71</b> .....	White Class VI Glass Filled Nylon
<b>-9</b> .....	Clear Polycarbonate	<b>-U75</b> .....	Blue Class VI Glass Filled Nylon
<b>-6005</b> .....	Animal-Free Polypropylene	<b>-VP1</b> .....	Animal-Free Polyethylene
<b>-6012</b> .....	Animal-Free Black Polypropylene		

## Founding Member BPSA - Bio-Process Systems Alliance

BPSA is a unique industry-led non-profit group whose aim is to encourage and advance the adoption and implementation of single-use manufacturing systems through education, sharing of best practices, development of consensus guidelines and business-to-business networking opportunities. Nordson MEDICAL is a participating member of BPSA and is also represented on the Executive Board.



## Bio-Process Systems Alliance

---

### *Advancing Single-Use Worldwide*

### **Nordson MEDICAL**

Nordson MEDICAL is your partner in the global life sciences market bringing you the combined excellence of Value Plastics' precision plastic fluid components, biomaterial delivery devices, and Avalon Laboratories' catheter solutions, along with a wide range of capabilities, services, and customized OEM solutions.

Nordson MEDICAL is backed by the extensive resources of Nordson Corporation (Nasdaq: NDSN), the world leader in precision dispensing, fluid management and related technologies.

### **About the VP Product Line**

The Value Plastics product line includes over 5,000 fluid management components designed specifically for flexible tubing in different style and material combinations. Products include bioprocessing fittings, quick connect fittings, luer fittings, check valves, tube-to-tube fittings, and TC fittings with tubing IDs ranging from 1/16" to 1". We also offer custom component manufacturing, tubing, and select OEM components. The Value Plastics product line finds global application in demanding pharmaceutical and healthcare OEMs, research and specialty industrial applications.

### **Specialists in Pharmaceutical Development**

Nordson MEDICAL serves biotechnology manufacturers the world over. Whether they happen to manufacture therapeutics or vaccines, Nordson MEDICAL provides world-class single-use fluid transfer components to facilitate breakthrough advances in human and animal care pharmaceutical development.

### **Systems Integration**

Bioprocessing system integrators rely on quality fluid management components from Nordson MEDICAL. Nordson MEDICAL is a one-stop-shop and delivers unmatched standards-specific components time and again that are guaranteed to interconnect within any bioprocessing system regardless of the supplier. Our extensive product family can grow with you from pre-clinical to full-scale commercial products.

### **High-Purity Resins**

Made from high-purity resin materials for use with aggressive chemicals found in most pharmaceutical manufacturing plants, our plastic connectors offer broad chemical compatibility. Resins that are free of animal derivatives and adhere to standards such as ISO 10993 and USP Class VI, for example, are particularly important in biopharmaceutical applications.

### **Validation Packages**

Nordson MEDICAL performs resin and product tests, reducing the amount of testing required by our customers and aiding them in determining what level of tests they do need to perform. You can request extractables test data from our website, [www.nordsonmedical.com](http://www.nordsonmedical.com).

### **Your Trusted Source**

Nordson MEDICAL is your trusted source for bioprocessing products, offering regulatory information, part drawings, extractables data, biocompatibility data, and validation test data.

We provide a comprehensive design center to help instrumentation and equipment manufacturers achieve the highest level of performance from their applications. Offering off-the-shelf or custom-made products, optimal designs are executed producing reliable and cost-effective results that comply with the industry's strict regulations. Nordson MEDICAL also offers a full quality assurance staff who are available to assist when regulatory and technical questions arise.

Contact us to learn more about our bioprocessing capabilities.

TEL: +1 (970) 267-5200

TOLL FREE in USA: (888) 404-5837

**[www.bioprocesscomponents.com](http://www.bioprocesscomponents.com)**

**[www.nordsonmedical.com](http://www.nordsonmedical.com)**

# RQSeries

## Quick Connects

Nordson MEDICAL has developed a more robust alternative for bioprocessing needs with the RQC Series and RQX Series offering a cost effective solution for flexible tubing connections in single use systems. The connector set is best in fit, form and function, and features a user-friendly interface that includes a large guarded button for a secure lock to guard against disconnects, and lofted lead-in for improved ease of connection. The more reliable locking feature gives you peace of mind knowing your connection is secure.



**RQCF655 (-9024 -001)**  
**RQCF655 (-6005 -001)**  
 Female Open Flow, 600 Series Barb,  
 1/4" (6.4 mm) Tubing ID



**RQCF670 (-9024 -001)**  
**RQCF670 (-6005 -001)**  
 Female Open Flow, 600 Series Barb,  
 3/8" (9.5 mm) Tubing ID



**RQCFC (-9024 -001)**  
**RQCFC (-6005 -001)**  
 Female Cap



**RQCFL655 (-9024 -001)**  
**RQCFL655 (-6005 -001)**  
 Female Open Flow, 600 Series Barb,  
 1/4" (6.4 mm) Tubing ID, Locking Feature



**RQCFL670 (-9024 -001)**  
**RQCFL670 (-6005 -001)**  
 Female Open Flow, 600 Series Barb,  
 3/8" (9.5 mm) Tubing ID, Locking Feature



**RQCFLC (-9024 -001)**  
**RQCFLC (-6005 -001)**  
 Female Cap, Locking Feature



**RQCM655 (-9024 -001)**  
**RQCM655 (-6005 -001)**  
 Male Open Flow, 600 Series Barb,  
 Platinum-Cured Silicone O-Ring,  
 1/4" (6.4 mm) Tubing ID



**RQCM670 (-9024 -001)**  
**RQCM670 (-6005 -001)**  
 Male Open Flow, 600 Series Barb,  
 Platinum-Cured Silicone O-Ring,  
 3/8" (9.5 mm) Tubing ID



**RQCMP (-9024 -001)**  
**RQCMP (-6005 -001)**  
 Male Plug, Platinum-Cured Silicone  
 O-Ring

## Features & Benefits:

- Materials meet USP Class VI & ISO 10993 criteria
- Several connector configurations available in commonly used polypropylene & polycarbonate materials
- Large ergonomic button & thumb pad with secure latch & optional integrated locking mechanism
- Platinum-cured silicone o-rings
- Plugs & caps available to maintain fluid path integrity
- Supports cryogenic applications to -60°C
- Interworks with other similar quick connects found in the market

## Specifications:

### Materials:

- Polypropylene, Tinted Polycarbonate

### Sterilization:

- Gamma radiation stable, EtO compatible, autoclavable to 121°C for up to 20 minutes

### Testing:

- Bioburden, Cytotoxicity, Extractables

### RQC Series Tubing Sizes:

- 1/4" (6.4 mm) and 3/8" (9.5 mm) tubing IDs

### RQX Series Tubing Sizes:

- 3/8" (9.5 mm) and 1/2" (12.7 mm) tubing IDs



**RQXF670 (-9024 -001)**  
**RQXF670 (-6005 -001)**  
 Female Open Flow, 600 Series Barb,  
 3/8" (9.5 mm) Tubing ID



**RQXF680 (-9024 -001)**  
**RQXF680 (-6005 -001)**  
 Female Open Flow, 600 Series Barb,  
 1/2" (12.7 mm) Tubing ID



**RQXFC (-9024 -001)**  
**RQXFC (-6005 -001)**  
 Female Cap



**RQXFL670 (-9024 -001)**  
**RQXFL670 (-6005 -001)**  
 Female Open Flow, 600 Series Barb,  
 3/8" (9.5 mm) Tubing ID, Locking Feature



**RQXFL680 (-9024 -001)**  
**RQXFL680 (-6005 -001)**  
 Female Open Flow, 600 Series Barb, 1/2"  
 (12.7 mm) Tubing ID, Locking Feature



**RQXFLC (-9024 -001)**  
**RQXFLC (-6005 -001)**  
 Female Cap, Locking Feature



**RQXM670 (-9024 -001)**  
**RQXM670 (-6005 -001)**  
 Male Open Flow, 600 Series Barb,  
 Platinum-Cured Silicone O-Ring,  
 3/8" (9.5 mm) Tubing ID



**RQXM680 (-9024 -001)**  
**RQXM680 (-6005 -001)**  
 Male Open Flow, 600 Series Barb,  
 Platinum-Cured Silicone O-Ring,  
 1/2" (12.7 mm) Tubing ID



**RQXMP (-9024 -001)**  
**RQXMP (-6005 -001)**  
 Male Plug, Platinum-Cured Silicone  
 O-Ring

# PharmaLok™

## Clamps

Offering full flexibility in single-use applications, Nordson MEDICAL has developed ground-breaking clamp designs that simplify the assembly process by making it effortless to securely attach sanitary fittings to bag ports and filters. PharmaLok™ clamps are lightweight, easy to install, and feature a quick release. The clamps are specifically designed to meet the needs of busy pharmaceutical and bioprocessing laboratories and work with Nordson MEDICAL's SF Series sanitary fitting Mini and Maxi flanges, related caps and gaskets, and in conjunction with OEM filters and bioprocessing bags.

Nordson MEDICAL's PharmaLok™ clamps are ASME BPE compliant and operate at a maximum pressure of 80 psi. Single-use and easy-open clamp sizes include .5" to .75" and 1" to 1.5", and the tube clamp supports tubing sizes from .5" to 1.25".

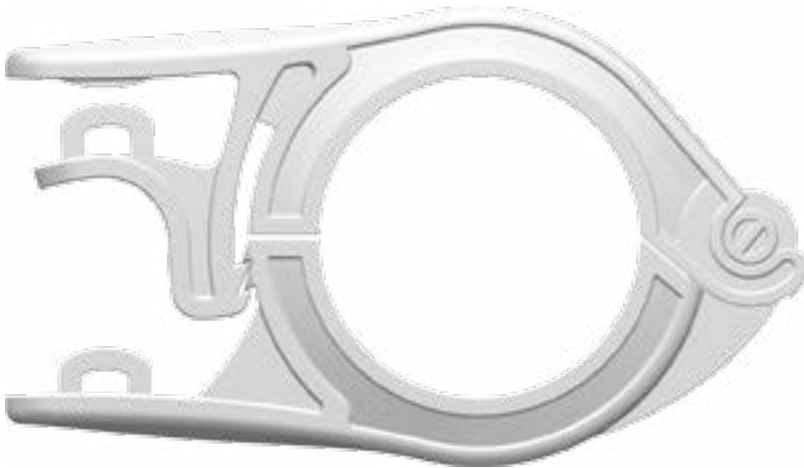

**CPAX150 (-U71)**  
Tri-Clover Easy-Open Clamp for Maxi Flange, 1" to 1.5"



**CPAN75 (-U71)**  
Tri-Clover Easy-Open Clamp for Mini Flange, .5" to .75"

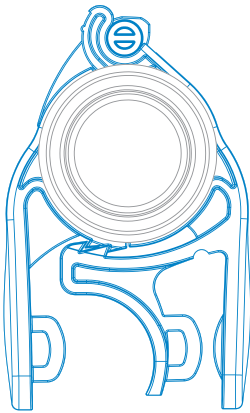

# Easy, 2 Click Closure

# 360° Compression

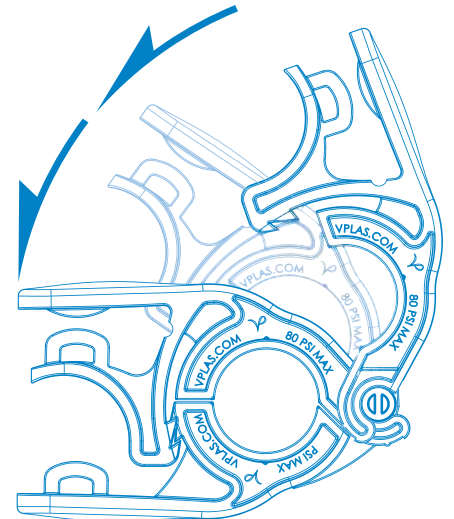

## Single-Use Clamps & Easy-Open Clamps Features & Benefits:

- ASME BPE 2014 DT-9.3.1 compliant & DIN compliant
- Easy to use, one-handed closure - no tools needed
- Tamper evident & zip tie compatible
- 360° compression
- Connects both plastic & stainless steel fittings
- SIP/CIP compatible

## Single-Use Clamps & Easy-Open Clamps Specifications:

### Materials:

- USP Class VI & ISO 11137 certified glass-filled nylon

### Sterilization:

- Gamma radiation up to 50 kGy, autoclavable up to 273°F (134°C) for a maximum of 30 minutes

### Sizes:

- .5" to .75" and 1" to 1.5"

### Operating Temperature:

- -94°F (-70°C) to 140°F (60°C)

### Maximum Pressure:

- 80 psi (conforms to ASME BPE-2014 PM-4.2.2)



### CPAX150 (-U75)

Tri-Clover Easy-Open Clamp for Maxi Flange, 1" to 1.5"



### CPAN75 (-U75)

Tri-Clover Easy-Open Clamp for Mini Flange, .5" to .75"



### CPAX150 (-U706)

Tri-Clover Easy-Open Clamp for Maxi Flange, 1" to 1.5"



### CPAN75 (-U706)

Tri-Clover Easy-Open Clamp for Mini Flange, .5" to .75"

# PharmaLok™

## Clamps

Pharmalok™ clamps provide a significant advancement for the industry, as a number of existing solutions either require tools for closure or consist of multiple components, which turns what should be a simple operation into a difficult and awkward process.

Easily operated with one hand, PharmaLok's patented design allows effortless attachment of fittings to bag ports and filters. The user simply rests the fitting in the PharmaLok's regulation-sized slot, lightly grips the surrounding handles, and listens for the sound of clicks to confirm a secure connection.

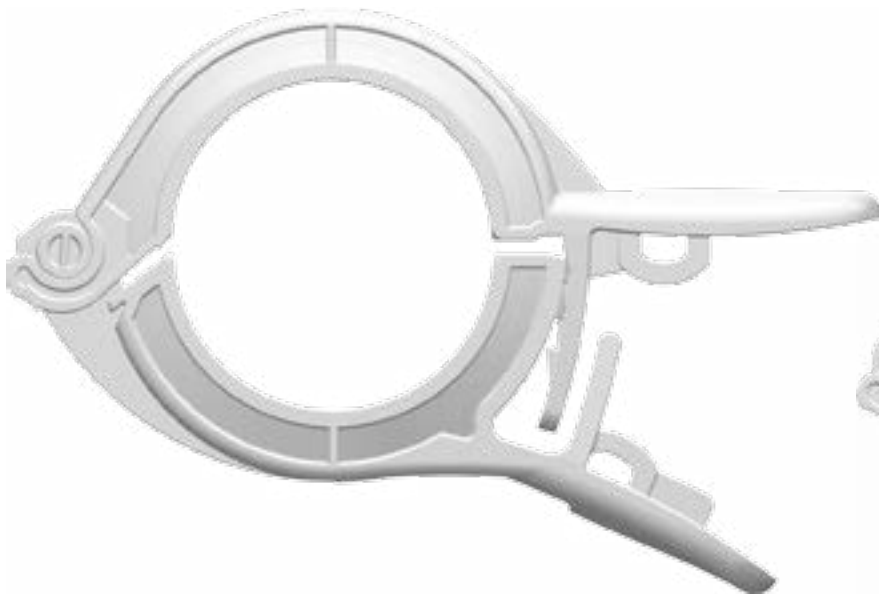

**CPX150 (-U71)**  
Single-Use Series Clamp, TC Version 1" to 1.5"



**CPN75 (-U71)**  
Single-Use Series Clamp, TC Version .5" to .75"

## PharmaLok™ Tube Clamp Compatibility

### Silicone and TPE Tubing

Tubing ID	Tubing OD						
	5/8"	3/4"	7/8"	1"	1-1/8"	1-1/4"	1-1/2"
1/2"	No	Yes	NA	NA	NA	NA	NA
5/8"	NA	No	Yes	Yes	NA	NA	NA
3/4"	NA	NA	NA	Yes	Yes	NA	NA
1"	NA	NA	NA	NA	NA	Yes	Yes

### Reinforced Silicone & Reinforced TPE Tubing

Tubing ID	Tubing OD				
	7/8"	1"	1-1/8"	1-1/4"	1-3/8"
1/2"	Yes	NA	NA	NA	NA
5/8"	NA	Yes	NA	NA	NA
3/4"	NA	NA	Yes	NA	NA
7/8"	NA	NA	NA	Yes	NA
1"	NA	NA	NA	NA	Yes



## Tube Clamps

### Features & Benefits:

- Designed for use with silicone & TPE tubing
- Easy to use, one-handed closure - no tools needed
- Tamper evident & zip tie compatible
- SIP/CIP compatible

## Tube Clamps

### Specifications:

#### Materials:

- USP Class VI & ISO 11137 certified glass-filled nylon

#### Sterilization:

- Gamma radiation up to 50 kGy, autoclavable up to 273°F (134°C) for a maximum of 30 minutes

#### Sizes:

- .5" to 1.25" tubing ID

#### Operating Temperature:

- -94°F (-70°C) to 140°F (60°C)

#### Operating Pressure:

- Up to 150 psi



**CPX150 (-U75)**  
Single-Use Series Clamp, TC Version 1" to 1.5"



**CPN75 (-U75)**  
Single-Use Series Clamp, TC Version .5" to .75"

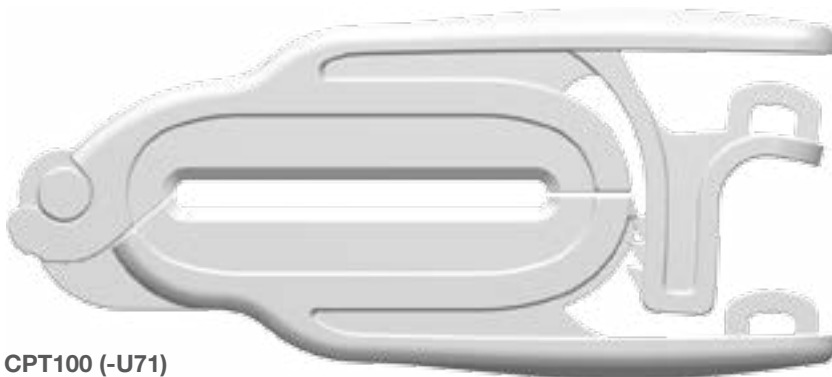

**CPT100 (-U71)**  
Tube Clamp, .5" to 1.25" Tube ID

# BIOClamp®

BioClamp® plastic quick-release clamps are specifically designed to meet the needs of busy pharmaceutical and bioprocessing laboratories, offering full flexibility in single-use applications. The clamps are specifically designed to work with Nordson MEDICAL's SF Series sanitary fitting Mini and Maxi flanges, related caps and gaskets, and in conjunction with OEM filters and bioprocessing bags. The clamps are lightweight, easy for technicians to install, and provide for convenient assembly release. BioClamps® reduce the distortion on polymeric components when subjected to heat, and the glass reinforced nylon is USP Class VI certified.

## Features & Benefits:

- Can be SIP repeatedly
- Can be autoclaved repeatedly at 134°C for 5 minutes
- Reduced distortion on polymeric components
- More compatible with current manufacturing than steel
  - Greater flexibility in operation & single-use disposal
- Applications
  - Bioprocessing
  - Single-use technology (SUS)
  - Drug discovery & development
  - Fluid transport
  - Pharmaceutical scale up
  - Sterile bag systems

## Specifications:

### Materials:

- Glass reinforced nylon 66
- USP Class VI certified

### Sizes:

- 1/2" (12.7 mm) to 8" (203.2 mm)

### Maximum Operating Pressure:

- 150 psig.

### Maximum Cumulative Gamma Dose:

- 40 kiloGrays



Reference Part Shown:  
**VNG150WHT**

### VNG075WHT

Clamp, Mini Flange, Glass Reinforced White Nylon, 1/2" (12.7 mm) to 3/4" (19.0 mm) Tubing ID

### VNG150WHT

Clamp, Maxi Flange, Glass Reinforced White Nylon, 1" (25.4 mm) to 1.5" (38.1 mm) Tubing ID

### VNG200WHT

Clamp, Maxi Flange, Glass Reinforced White Nylon, 2" (50.8 mm) Tubing ID

### VNG250WHT

Clamp, Maxi Flange, Glass Reinforced White Nylon, 2.5" (63.5 mm) Tubing ID

### VNG300WHT

Clamp, Maxi Flange, Glass Reinforced White Nylon, 3" (76.2 mm) Tubing ID

### VNG400WHT

Clamp, Maxi Flange, Glass Reinforced White Nylon, 4" (101.6 mm) Tubing ID

### VNG600WH

Clamp, Maxi Flange, Glass Reinforced White Nylon, 6" (152.4 mm) Tubing ID

### VNG800WH

Clamp, Maxi Flange, Glass Reinforced White Nylon, 8" (203.2 mm) Tubing ID

# BIOValve®

The BioValve® pinch valve is a precision restriction flow controller and shut-off valve for silicone tubing used in bioprocessing and pharmaceutical manufacturing applications. The threaded pitch can be calibrated to 2 mm per turn to minimize flow path turbulence. Available in 1/4" (6.4 mm) and 1" (12.7 mm), BioValve® is perfect for precise operation. The valves can be SIP repeatedly, and they can also be autoclaved at 134°C for 5 minutes.

## Specifications:

### Materials:

- Glass reinforced nylon 66
- USP Class VI certified

### Sizes:

- 1/4" (6.4 mm) to 1" (12.7 mm)

### Maximum Operating Pressure:

- 150 psig.

### Maximum Cumulative Gamma Dose:

- 40 kiloGrays



### **VBV0500NW**

Pinch Valve, Mini, Glass Reinforced White Nylon,  
1/4" (6.4 mm) to 1/2" (12.7 mm) Tubing ID



### **VBV1000NW**

Pinch Valve, Maxi, Glass Reinforced White Nylon,  
1/2" (12.7 mm) to 1" (25.4 mm) Tubing ID

# SF Series

## Sanitary Fittings

The SF Series sanitary fittings are based on design concepts calling for a heavy-duty part with superior side load strength, while providing superior flow-through characteristics, making them the connectors of choice for single-use bioprocesses. Pharmaceutical professionals find these plastic fittings offer all the benefits of disposable parts while offering performance capabilities not found in earlier versions of flanged fittings.

### Need Samples for Evaluation?

You can call to request most of our standard product in quantities of 5, or less, for free application evaluation.

+1 (970) 267-5200  
Toll Free: (888) 404-5837



**SFMN655 (-6005 -J1A)**  
Sanitary Fitting, Mini Flange 3/4" to 600 Series Barb, 1/4" (6.4 mm) Tubing ID



**SFMN670 (-6005 -J1A)**  
Sanitary Fitting, Mini Flange 3/4" to 600 Series Barb, 3/8" (9.5 mm) Tubing ID



**SFMN680 (-6005 -J1A)**  
Sanitary Fitting, Mini Flange 3/4" to 600 Series Barb, 1/2" (12.7 mm) Tubing ID



**SFMN6100 (-6005 -J1A)**  
Sanitary Fitting, Mini Flange 3/4" to 600 Series Barb, 3/4" (19.0 mm) Tubing ID



**SFMNC (-6005 -J1A)**  
Sanitary Fitting, Mini Cap 3/4"

## Features & Benefits:

- Animal-free materials
  - No BSE documentation required
- Radiused flow surfaces
  - Smooth uninterrupted flow
- Mini & Maxi sizes
  - Easy to retrofit current operations & works with commercially available biopharm clamps
- No particulate build-up
  - Interior surface controlled to 15 Ra microinch

## Specifications:

### Materials:

- Animal-Free Polypropylene, Natural PVDF

### Tubing Sizes:

- 1/4", 3/8", 1/2", 3/4", 1"

### Leak Resistance:

- Tested at 80 psi air under water for 90 seconds

### Tubing Removal Force:

- 1/4" PP with C-Flex® shore A tubing: 21 lbs.
- 1/2" PP with C-Flex® shore A tubing: 89 lbs.
- 1" PP with C-Flex® shore A tubing: 121 lbs.



### SFMX655 (-6005 -J1A)

Sanitary Fitting, Maxi Flange 1-1/2" to 600 Series Barb, 1/4" (6.4 mm) Tubing ID



### SFMX670 (-6005 -J1A)

Sanitary Fitting, Maxi Flange 1-1/2" to 600 Series Barb, 3/8" (9.5 mm) Tubing ID



### SFMX680 (-6005 -J1A)

Sanitary Fitting, Maxi Flange 1-1/2" to 600 Series Barb, 1/2" (12.7 mm) Tubing ID



### SFMX6100 (-6005 -J1A)

Sanitary Fitting, Maxi Flange 1-1/2" to 600 Series Barb, 3/4" (19.0 mm) Tubing ID



### SFMX6110 (-6005 -J1A)

Sanitary Fitting, Maxi Flange 1-1/2" to 600 Series Barb, 1" (25.4 mm) Tubing ID



### SFMXC (-6005 -J1A)

Sanitary Fitting, Maxi Cap 1-1/2"

# SF Series

## Instrument Tees

SF Series Instrument Tees work well with existing pharmaceutical instrumentation and are available in 1/2" and 3/4" tubing IDs. Critical to a successful single-use implementation, the fittings work for pressure testing, fluid transfer, and filtration applications. The configuration is a standard 1.5" TC style interface on the instrument side and tee style for the fluid path. The fittings also utilize Nordson MEDICAL's popular 600 series barb, which is ideally suited for silicone and TPE tubing. Constructed of either Nordson MEDICAL's standard polyethylene resin or as demand warrants, RENOLIT SOLMED Granuflex 4301 resin, the instrument tees utilize materials found in many single-use bags being used around the world.

### Part Drawings Online!

Nordson MEDICAL provides dimensional drawings available for download for all of its fittings.  
[www.nordsonmedical.com](http://www.nordsonmedical.com)

### Technical Assistance

Trying to choose the correct part? Need more material information than is published in this catalog? Call Nordson MEDICAL Technical Support at (970) 267-5200.



### A Quality Stainless Steel Alternative:

SF Series Instrument Tees ship with an optional isolator that system integrators and assembly houses can heat seal into the TC side. Adding one of Nordson MEDICAL's end caps and a PharmaLok™ Easy-Open Clamp completes the assembly and makes it ready for sterilization and shipment to end user facilities.

## Features & Benefits:

- Works with existing pharmaceutical instrumentation
- Single-use technology
- ASME BPE compliant interface on the instrument side
- Tee style for the fluid path
- 600 series barb
- Common industry materials

## Specifications:

### Materials:

- Animal-Free Polyethylene
- RENOLIT SOLMED Granuflex 4301 resin

### Tubing Sizes:

- 1/2" and 3/4" tubing IDs

### Configuration:

- 1.5" TC style



### **SFMXT680 (-VP1 -CM056)**

Sanitary Fitting Instrument Tee, Maxi Flange to 600 Series Barb, 1/2" (12.7 mm) Tubing ID, Animal-free Natural Polyethylene



### **SFMXT6110 (-VP1 -CM056)**

Sanitary Fitting Instrument Tee, Maxi Flange to 600 Series Barb, 1" (25.4 mm) Tubing ID, Animal-free Natural Polyethylene

# GASKETS

Nordson MEDICAL's gasket material options include Class VI compliant PTFE/EPDM and platinum-cured silicone in sizes that fit the 3/4" Mini Flange, 1-1/2" Maxi Flange, 2" Flange, and 3" Flange. Keeping customer requirements in mind, these components were manufactured for applications requiring the highest sanitary standards and chemical purity.

Tuf-flex® sanitary gaskets are unitized and will maintain ID without re-torquing or leaking.



## **GMX455 (-PX)**

Molded Gasket for Maxi Flange SFMX Series Fittings



## **G40MPGR-TF150 (-E)**

Molded Tuf-Flex® Gasket for Maxi Flange SFMX Series Fittings



## **GMN450 (-PX)**

Molded Gasket for Mini Flange SFMN Series Fittings



## **G42MPGR-TF075 (-E)**

Molded Tuf-Flex® Gasket for Mini Flange SFMN Series Fittings



## Features & Benefits:

- Class VI compliant materials
- 100% virgin raw materials & colorants
- Excellent wear performance
- Maintains seal integrity
- Complete material traceability

## Specifications:

### Materials:

- PTFE/EPDM
- Platinum-cured silicone

### Gasket Sizes:

- 3/4" (19.0 mm) to 3" (76.2 mm)



### **G424TRX-0200**

Molded Gasket for 2" Flange Fittings, Platinum-Cured Silicone



### **G424TRX-0300**

Molded Gasket for 3" Flange Fittings, Platinum-Cured Silicone

### **GM4749TRX-0600**

Molded Gasket for 6" Flange Fittings, Platinum-Cured Silicone



# BAG

## Ports

Nordson MEDICAL's high tech series of bag ports offers a variety of benefits to the biopharmaceutical industry. Value Pharma™ resin features animal derivative free qualification, USP Class VI certification, and the guarantee of heat sealing and conformance with polyethylene bags, and also provides a strong, 24-hour resistance to alcohol stress cracking. RENOLIT SOLMED Granuflex 4301 resin demonstrates lower leachable levels and high purity. These bag ports not only conform with frequently utilized tubing sizes, but they are also designed to ASME BPE ferrule specifications, allowing them to work with leading industry fittings, filters and other devices. However, the most notable of the bag ports' specifications are the parabolic lead and the alignment ribs. These two features, respectively, reduce the amount of time it takes to drain a bag by 24 percent and improve flow dynamics through the port.



### **SFBP630 (-VP1)**

Bag Port with 600 Series Barb, Value Pharma™ Resin, 1/8" (3.2 mm) Tubing ID



### **SFBP655 (-VP1 -CM056)**

Bag Port with 600 Series Barb, Value Pharma™ Resin, Granuflex Polyethylene, 1/4" (6.4 mm) Tubing ID



### **SFBP670 (-VP1)**

Bag Port with 600 Series Barb, Value Pharma™ Resin, 3/8" (9.5 mm) Tubing ID



### **SFBP680 (-VP1 -CM056)**

Bag Port with 600 Series Barb, Value Pharma™ Resin, Granuflex Polyethylene, 1/2" (12.7 mm) Tubing ID



### **SFBP6100 (-VP1 -CM056)**

Bag Port with 600 Series Barb, Value Pharma™ Resin, Granuflex Polyethylene, 3/4" (19.0 mm) Tubing ID



### **SFBP6110 (-VP1 -CM056)**

Bag Port with 600 Series Barb, Value Pharma™ Resin, Granuflex Polyethylene, 1" (25.4 mm) Tubing ID

## Features & Benefits:

- Compliant to ASME BPE ferrule specifications
  - Works with leading industry single-use bags
- Parabolic lead
  - Reduces the time it takes to drain a bag by 17% to 24%
  - Similar results for both fluid and powder applications
- Alignment ribs
  - Improves fluid dynamics of flow through the port
- USP Class VI certification
- Resins ensure heat sealing with polyethylene bags

## Specifications:

### Materials:

- Value Pharma™ resin
  - Animal derivative free
  - Resistant to alcohol stress cracking
- RENOLIT SOLMED Granuflex 4301 resin
  - Animal derivative free
  - Demonstrates lower leachable levels & high purity

### Tubing Sizes:

- 1/8" (3.2 mm) to 1" (25.4 mm) and 1-1/2" (38.1 mm) to 3" (76.2 mm) TC style

### Flow Rate:

- 8.37 gallons per minute



### SFBPF1 (-VP1)

Bag Port with Ferrule Fitting to 1-1/2" TC Connection



### SFBPF3 (-VP1)

Bag Port with Ferrule Fitting to 3" TC Connection

## Looking for Something Different?

Most of our best product ideas have come from you, our customers. While we pride ourselves on our extensive product offering, we recognize that your needs are ever-changing and that our products, too, must adapt to your needs.

If there's a new product you think Nordson MEDICAL should make, please send us an email at [designcenter@nordsonmedical.com](mailto:designcenter@nordsonmedical.com) describing your product concept in as much detail as you desire. We will contact you with any questions, and who knows - the next catalog edition could include products YOU told us to build.

# OPPOSING

## Barb Ports

Nordson MEDICAL offers the biomedical market opposing barb ports. The larger ports can be used in filling applications, and they are also ideally suited to work with sensors. Value Pharma™ resin features animal derivative free qualification, USP Class VI certification, and the guarantee of heat sealing and conformance with polyethylene bags. The resin also provides a strong, 24-hour resistance to alcohol stress cracking. RENOLIT SOLMED Granuflex 4301 resin demonstrates lower leachable levels and high purity.



**SFBP635/635 (-VP1)**  
Dip Tube (Opposable Barbs) with Two  
600 Series Barbs, Value Pharma™  
Resin, 3/16" (4.8 mm) Tubing ID



**SFBP655/655 (-VP1 -CM056)**  
Dip Tube (Opposable Barbs) with Two  
600 Series Barbs, Value Pharma™  
Resin, Granuflex Polyethylene, 1/4"  
(6.4 mm) Tubing ID



**SFBP670/670 (-VP1)**  
Dip Tube (Opposable Barbs) with Two  
600 Series Barbs, Value Pharma™  
Resin, 3/8" (9.5 mm) Tubing ID

## Features & Benefits:

- Easy to heat seal into film material
- Can be used in filling applications
- Works great with silicone & TPE style tubing
- Better tube retention
- 600 Series barb sizes
- Animal-free polyethylene
- Materials meet USP Class VI criteria

## Specifications:

### Materials:

- Value Pharma™ resin
  - Animal derivative free
  - Resistant to alcohol stress cracking
- RENOLIT SOLMED Granuflex 4301 resin
  - Animal derivative free
  - Demonstrates lower leachable levels & high purity

### Tubing Sizes:

- 3/16" (4.8 mm) to 3/4" (19.0 mm)

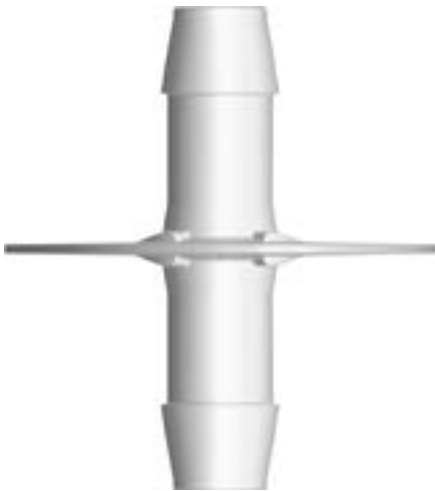

### SFBP680/680 (-VP1)

Dip Tube (Opposable Barbs) with Two 600 Series Barbs, Value Pharma™ Resin, 1/2" (12.7 mm) Tubing ID

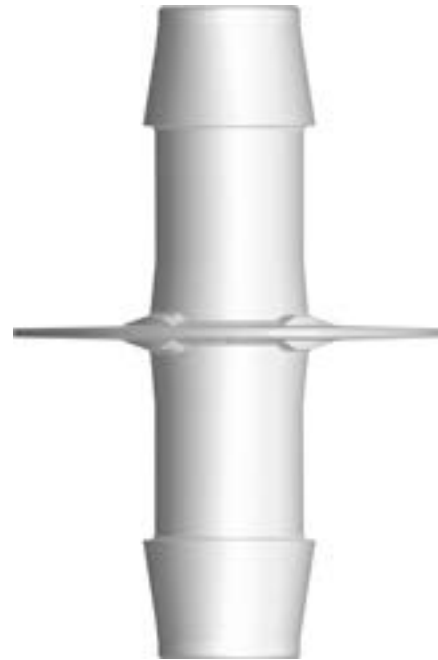

### SFBP6100/6100 (-VP1)

Dip Tube (Opposable Barbs) with Two 600 Series Barbs, Value Pharma™ Resin, 3/4" (19.0 mm) Tubing ID

# TUBE-TO-TUBE

## Fittings

Nordson MEDICAL offers barbed tubing fittings and tubing connectors in sizes ranging from 1/16" (1.6 mm) to 1" (25.4 mm) tubing ID in over 100 separate configurations in nylon, polypropylene, polycarbonate and PVDF, with other engineering resins available on special order. Available barbed fitting styles include straight tube connectors, elbow fittings, tee fittings, crosses, Y (wye) connectors, multi-port connectors, and multiple straight, elbow and tee reducer combinations.

Several barb styles are offered to provide designers the widest range of assembly forces, pull-off resistance and blow-off resistance – without the need for clamps.

## Straight Through Fittings



### Reference Part Shown: N670

#### **6060 (-1 -2 -6005 -9 -9002 -J1A)**

Straight Through Connector with Classic Series Barb, 1/4" (6.4 mm) Tubing ID

#### **N070 (-0 -6005 -9)**

Straight Through Connector with 500 Series Barb, 3/8" (9.5 mm) Tubing ID

#### **N080 (-0 -6005 -9)**

Straight Through Connector with 500 Series Barb, 1/2" (12.7 mm) Tubing ID

#### **N055 (-1 -2 -6005 -9 -J1A)**

Straight Through Connector with 500 Series Barb, 1/4" (6.4 mm) Tubing ID

#### **N670 (-6005 -9 -J1A)**

Straight Through Connector with 600 Series Barb, 3/8" (9.5 mm) Tubing ID

#### **N680 (-6005 -9 -J1A)**

Straight Through Connector with 600 Series Barb, 1/2" (12.7 mm) Tubing ID

#### **N065 (-1 -2 -6005 -9 -J1A)**

Straight Through Connector with 500 Series Barb, 5/16" (8.0 mm) Tubing ID

#### **N970 (-9)**

Straight Through Connector with 900 Series Barb, 3/8" (9.5 mm) Tubing ID

#### **N975 (-9)**

Straight Through Connector with 900 Series Barb, 1/2" (12.7 mm) Tubing ID

Due to size, we are not able to display all large Tube-to-Tube fittings. Please see [www.nordsonmedical.com](http://www.nordsonmedical.com) for part reference. Minimum package quantities vary by tube IDs. Please verify minimum package sizes when placing orders.

**N090 (-0 -6005 -9)**

Straight Through Connector with 500 Series Barb, 5/8" (16.0 mm) Tubing ID

**N690 (-0 -6005 -9)**

Straight Through Connector with 600 Series Barb, 5/8" (16.0 mm) Tubing ID

**N100 (-0 -6005)**

Straight Through Connector with 500 Series Barb, 3/4" (19.0 mm) Tubing ID

**N6100 (-6005)**

Straight Through Connector with 600 Series Barb, 3/4" (19.0 mm) Tubing ID

**N110 (-0 -6005)**

Straight Through Connector with 500 Series Barb, 1" (25.4 mm) Tubing ID

**N6110 (-6005)**

Straight Through Connector with 600 Series Barb, 1" (25.4 mm) Tubing ID

## Custom Assembly

We produce standard components to fit your current assemblies and devices, but we also provide custom solutions by applying a variety of assembly options, such as joining fittings, connectors, filters, and other components to tubing. From systems using a single fitting to complex configurations utilizing various components, we can design complete assemblies to your requirements.

# TUBE-TO-TUBE

## Fittings

Nordson MEDICAL offers barbed tubing fittings and tubing connectors in sizes ranging from 1/16" (1.6 mm) to 1" (25.4 mm) tubing ID in over 100 separate configurations in nylon, polypropylene, polycarbonate and PVDF, with other engineering resins available on special order. Available barbed fitting styles include straight tube connectors, elbow fittings, tee fittings, crosses, Y (wye) connectors, multi-port connectors, and multiple straight, elbow and tee reducer combinations.

Several barb styles are offered to provide designers the widest range of assembly forces, pull-off resistance and blow-off resistance – without the need for clamps.

## Straight Through Reducer Fittings



### Reference Part Shown: N070/13

#### **3060 (-1 -2 -6005 -9 -J1A -J1A2)**

Straight Through Reduction Connector with Classic Series Barb, 1/4" (6.4 mm) and 1/8" (3.2 mm) Tubing ID

#### **N055/013 (-1 -2 -6005 -9 -J1A)**

Straight Through Reduction Connector with 500 Series Barb, 1/4" (6.4 mm) and 1/8" (3.2 mm) Tubing ID

#### **4060 (-1 -2 -6005 -9 -J1A)**

Straight Through Reduction Connector with Classic Series Barb, 1/4" (6.4 mm) and 5/32" (4.0 mm) Tubing ID

#### **N055/025 (-1 -2 -6005 -9 -J1A)**

Straight Through Reduction Connector with 500 Series Barb, 1/4" (6.4 mm) and 5/32" (4.0 mm) Tubing ID

#### **5060 (-1 -2 -6005 -9 -9002 -J1A)**

Straight Through Reduction Connector with Classic Series Barb, 1/4" (6.4 mm) and 3/16" (4.8 mm) Tubing ID

#### **N055/035 (-1 -2 -6005 -9 -J1A)**

Straight Through Reduction Connector with 500 Series Barb, 1/4" (6.4 mm) and 3/16" (4.8 mm) Tubing ID

#### **N065/025 (-1 -2 -6005 -9 -J1A)**

Straight Through Reduction Connector with 500 Series Barb, 5/16" (8.0 mm) and 5/32" (4.0 mm) Tubing ID

#### **N065/035 (-1 -2 -6005 -9 -J1A)**

Straight Through Reduction Connector with 500 Series Barb, 5/16" (8.0 mm) and 3/16" (4.8 mm) Tubing ID

#### **N065/055 (-1 -2 -6005 -9 -J1A)**

Straight Through Reduction Connector with 500 Series Barb, 5/16" (8.0 mm) and 1/4" (6.4 mm) Tubing ID

#### **N070/013 (-0 -6005 -9 -9002 -J1A)**

Straight Through Reduction Connector with 500 Series Barb, 3/8" (9.5 mm) and 1/8" (3.2 mm) Tubing ID

#### **N070/055 (-0 -6005 -9)**

Straight Through Reduction Connector with 500 Series Barb, 3/8" (9.5 mm) and 1/4" (6.4 mm) Tubing ID

#### **N670/655 (-6005 -9 -J1A)**

Straight Through Reduction Connector with 600 Series Barb, 3/8" (9.5 mm) and 1/4" (6.4 mm) Tubing ID

#### **N080/055 (-0 -6005 -9)**

Straight Through Reduction Connector with 500 Series Barb, 1/2" (12.7 mm) and 1/4" (6.4 mm) Tubing ID

#### **N680/655 (-6005 -9 -J1A)**

Straight Through Reduction Connector with 600 Series Barb, 1/2" (12.7 mm) and 1/4" (6.4 mm) Tubing ID

#### **N080/070 (-0 -6005 -9)**

Straight Through Reduction Connector with 500 Series Barb, 1/2" (12.7 mm) and 3/8" (9.5 mm) Tubing ID



Due to size, we are not able to display all large Tube-to-Tube fittings. Please see [www.nordsonmedical.com](http://www.nordsonmedical.com) for part reference. Minimum package quantities vary by tube IDs. Please verify minimum package sizes when placing orders.

**N680/670 (-6005 -9)**

Straight Through Reduction Connector with 600 Series Barb, 1/2" (12.7 mm) and 3/8" (9.5 mm) Tubing ID

**N090/055 (-0 -6005)**

Straight Through Reduction Connector with 500 Series Barb, 5/8" (16.0 mm) and 1/4" (6.4 mm) Tubing ID

**N690/655 (-6005 -9)**

Straight Through Reduction Connector with 600 Series Barb, 5/8" (16.0 mm) and 1/4" (6.4 mm) Tubing ID

**N090/070 (-0 -6005)**

Straight Through Reduction Connector with 500 Series Barb, 5/8" (16.0 mm) and 3/8" (9.5 mm) Tubing ID

**N690/670 (-6005 -9)**

Straight Through Reduction Connector with 600 Series Barb, 5/8" (16.0 mm) and 3/8" (9.5 mm) Tubing ID

**N6100/670 (-6005)**

Straight Through Reduction Connector with 600 Series Barb, 3/4" (19.0 mm) and 3/8" (9.5 mm) Tubing ID

**N100/080 (-0 -6005)**

Straight Through Reduction Connector with 500 Series Barb, 3/4" (19.0 mm) and 1/2" (12.7 mm) Tubing ID

**N6100/680 (-6005)**

Straight Through Reduction Connector with 600 Series Barb, 3/4" (19.0 mm) and 1/2" (12.7 mm) Tubing ID

**N6110/680 (-6005)**

Straight Through Reduction Connector with 600 Series Barb, 1" (25.4 mm) and 1/2" (12.7 mm) Tubing ID

**N110/100 (-0 -6005)**

Straight Through Reduction Connector with 500 Series Barb, 1" (25.4 mm) and 3/4" (19.0 mm) Tubing ID

**N6110/6100 (-6005 -9)**

Straight Through Reduction Connector with 600 Series Barb, 1" (25.4 mm) and 3/4" (19.0 mm) Tubing ID

**Need it Fast?**

You can order any of our 5,000+ parts online now with no order \$ minimums, 24 hours a day, 7 days a week!  
[www.nordsonmedical.com](http://www.nordsonmedical.com)

# TUBE-TO-TUBE

## Fittings

Nordson MEDICAL offers barbed tubing fittings and tubing connectors in sizes ranging from 1/16" (1.6 mm) to 1" (25.4 mm) tubing ID in over 100 separate configurations in nylon, polypropylene, polycarbonate and PVDF, with other engineering resins available on special order. Available barbed fitting styles include straight tube connectors, elbow fittings, tee fittings, crosses, Y (wye) connectors, multi-port connectors, and multiple straight, elbow and tee reducer combinations.

Several barb styles are offered to provide designers the widest range of assembly forces, pulloff resistance and blowoff resistance – without the need for clamps.

## Elbow Fittings



### Reference Part Shown: L070

#### **L60 (-1 -2 -6005 -J1A)**

Elbow Connector with Classic Series Barb, 1/4" (6.4 mm) Tubing ID

#### **L070 (-0 -6005)**

Elbow Connector with 500 Series Barb, 3/8" (9.5 mm) Tubing ID

#### **L970 (-9)**

Elbow Connector with 900 Series Barb, 3/8" (9.5 mm) Tubing ID

#### **L080 (-0 -6005)**

Elbow Connector with 500 Series Barb, 1/2" (12.7 mm) Tubing ID

#### **L975 (-9)**

Elbow Connector with 900 Series Barb, 1/2" (12.7 mm) Tubing ID

#### **L090 (-0 -6005)**

Elbow Connector with 500 Series Barb, 5/8" (16.0 mm) Tubing ID

#### **L100 (-0 -6005)**

Elbow Connector with 500 Series Barb, 3/4" (19.0 mm) Tubing ID

#### **L110 (-0 -6005)**

Elbow Connector with 500 Series Barb, 1" (25.4 mm) Tubing ID

#### **L6110 (-6005)**

Elbow Connector with 600 Series Barb, 1" (25.4 mm) Tubing ID

#### **CF494 (-6005)**

Low-Profile Elbow Connector with Custom 600 Series Barb, 1" (25.4 mm) Tubing ID

Due to size, we are not able to display all large Tube-to-Tube fittings. Please see [www.nordsonmedical.com](http://www.nordsonmedical.com) for part reference. Minimum package quantities vary by tube IDs. Please verify minimum package sizes when placing orders.

## Elbow Reducer Fittings



### Reference Part Shown: L070/055

#### **L070/055 (-0 -6005)**

Elbow Reduction Connector with 500 Series Barb, 3/8" (9.5 mm) and 1/4" (6.4 mm) Tubing ID

#### **L080/070 (-0 -6005)**

Elbow Reduction Connector with 500 Series Barb, 1/2" (12.7 mm) and 3/8" (9.5 mm) Tubing ID

#### **L100/080 (-0 -6005)**

Elbow Reduction Connector with 500 Series Barb, 3/4" (19.0 mm) and 1/2" (12.7 mm) Tubing ID

#### **L110/100 (-0 -6005)**

Elbow Reduction Connector with 500 Series Barb, 1" (25.4 mm) and 3/4" (19.0 mm) Tubing ID

### Need More Details?

Part drawings, minimum order quantities, and CAD requests can be found online at [www.nordsonmedical.com](http://www.nordsonmedical.com).

# TUBE-TO-TUBE

## Fittings

Nordson MEDICAL offers barbed tubing fittings and tubing connectors in sizes ranging from 1/16" (1.6 mm) to 1" (25.4 mm) tubing ID in over 100 separate configurations in nylon, polypropylene, polycarbonate and PVDF, with other engineering resins available on special order. Available barbed fitting styles include straight tube connectors, elbow fittings, tee fittings, crosses, Y (wye) connectors, multi-port connectors, and multiple straight, elbow and tee reducer combinations.

Several barb styles are offered to provide designers the widest range of assembly forces, pulloff resistance and blowoff resistance – without the need for clamps.

## Tee Fittings



### Reference Part Shown: T070

#### **T60 (-1 -2 -6005 -9 -J1A)**

Tee Connector with Classic Series Barb, 1/4" (6.4 mm) Tubing ID

#### **T970 (-9)**

Tee Connector with 900 Series Barb, 3/8" (9.5 mm) Tubing ID

#### **T975 (-9)**

Tee Connector with 900 Series Barb, 1/2" (12.7 mm) Tubing ID

#### **T6100 (-6005)**

Tee Connector with 600 Series Barb, 3/4" (19.0 mm) Tubing ID

#### **T055 (-6005)**

Tee Connector with 500 Series Barb, 1/4" (6.4 mm) Tubing ID

#### **T080 (-0 -6005 -9)**

Tee Connector with 500 Series Barb, 1/2" (12.7 mm) Tubing ID

#### **T690 (-6005 -9)**

Tee Connector with 600 Series Barb, 5/8" (16.0 mm) Tubing ID

#### **T110 (-0 -6005)**

Tee Connector with 500 Series Barb, 1" (25.4 mm) Tubing ID

#### **T070 (-0 -6005 -9)**

Tee Connector with 500 Series Barb, 3/8" (9.5 mm) Tubing ID

#### **T680 (-6005 -9 -J1A)**

Tee Connector with 600 Series Barb, 1/2" (12.7 mm) Tubing ID

#### **T100 (-0 -6005 -9)**

Tee Connector with 500 Series Barb, 3/4" (19.0 mm) Tubing ID

#### **T6110 (-6005)**

Tee Connector with 600 Series Barb, 1" (25.4 mm) Tubing ID

#### **T670 (-1 -6005 -9 -J1A)**

Tee Connector with 600 Series Barb, 3/8" (9.5 mm) Tubing ID

Due to size, we are not able to display all large Tube-to-Tube fittings. Please see [www.nordsonmedical.com](http://www.nordsonmedical.com) for part reference. Minimum package quantities vary by tube IDs. Please verify minimum package sizes when placing orders.

## Tee Reducer Fittings



### Reference Part Shown: T070/055

#### **T360/220 (-1 -2 -6005 -9 -J1A)**

Tee Reduction Connector with 200 and 300 Series Barbs, 1/4" (6.4 mm) and 3/32" (2.4 mm) Tubing ID

#### **T360/230 (-1 -2 -6005 -9 -J1A)**

Tee Reduction Connector with 200 and 300 Series Barbs, 1/4" (6.4 mm) and 1/8" (3.2 mm) Tubing ID

#### **T360/250 (-1 -2 -6005 -9 -J1A)**

Tee Reduction Connector with 200 and 300 Series Barbs, 1/4" (6.4 mm) and 3/16" (4.8 mm) Tubing ID

#### **T070/055 (-0 -6005 -9)**

Tee Reduction Connector with 500 Series Barbs, 3/8" (9.5 mm) and 1/4" (6.4 mm) Tubing ID

#### **T080/055 (-0 -6005 -9)**

Tee Reduction Connector with 500 Series Barb, 1/2" (12.7 mm) and 1/4" (6.4 mm) Tubing ID

#### **T080/070 (-0 -6005 -9)**

Tee Reduction Connector with 500 Series Barbs, 1/2" (12.7 mm) and 3/8" (9.5 mm) Tubing ID

#### **T100/080 (-0 -6005 -9)**

Tee Reduction Connector with 500 Series Barbs, 3/4" (19.0 mm) and 1/2" (12.7 mm) Tubing ID

#### **T110/100 (-0 -6005)**

Tee Reduction Connector with 500 Series Barb, 1" (25.4 mm) and 3/4" (19.0 mm) Tubing ID

# TUBE-TO-TUBE

## Fittings

Nordson MEDICAL offers barbed tubing fittings and tubing connectors in sizes ranging from 1/16" (1.6 mm) to 1" (25.4 mm) tubing ID in over 100 separate configurations in nylon, polypropylene, polycarbonate and PVDF, with other engineering resins available on special order. Available barbed fitting styles include straight tube connectors, elbow fittings, tee fittings, crosses, Y (wye) connectors, multi-port connectors, and multiple straight, elbow and tee reducer combinations.

Several barb styles are offered to provide designers the widest range of assembly forces, pull-off resistance and blow-off resistance – without the need for clamps.

## Y Fittings



Reference Part Shown: Y070

### **Y260 (-1 -2 -6005 -9 -9002 -J1A)**

Y Connector with 200 Series Barb,  
1/4" (6.4 mm) Tubing ID

### **Y460 (-1 -2 -6005 -9 -J1A)**

Y Connector with 400 Series Barb,  
1/4" (6.4 mm) Tubing ID

### **Y055 (-6005)**

Y Connector with 500 Series Barb,  
1/4" (6.4 mm) Tubing ID

### **Y070 (-0 -6005 -9)**

Y Connector with 500 Series Barb,  
3/8" (9.5 mm) Tubing ID

### **Y670 (-6005 -9 -J1A)**

Y Connector with 600 Series Barb,  
3/8" (9.5 mm) Tubing ID

### **Y080 (-0 -6005 -9)**

Y Connector with 500 Series Barb,  
1/2" (12.7 mm) Tubing ID

### **Y680 (-6005 -9 -J1A)**

Y Connector with 600 Series Barb,  
1/2" (12.7 mm) Tubing ID

### **Y090 (-0 -6005 -J1A)**

Y Connector with 500 Series Barb,  
5/8" (16.0 mm) Tubing ID

### **Y690 (-6005)**

Y Connector with 600 Series Barb,  
5/8" (16.0 mm) Tubing ID

### **Y100 (-0 -6005 -J1A)**

Y Connector with 500 Series Barb,  
3/4" (19.0 mm) Tubing ID

### **Y6100 (-6005)**

Y Connector with 600 Series Barb,  
3/4" (19.0 mm) Tubing ID

### **Y110 (-0 -6005)**

Y Connector with 500 Series Barb,  
1" (25.4 mm) Tubing ID

### **Y6110 (-6005)**

Y Connector with 600 Series Barb,  
1" (25.4 mm) Tubing ID

Due to size, we are not able to display all large Tube-to-Tube fittings. Please see [www.nordsonmedical.com](http://www.nordsonmedical.com) for part reference. Minimum package quantities vary by tube IDs. Please verify minimum package sizes when placing orders.

## Multiport Fittings

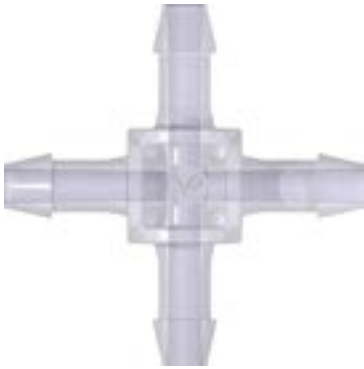

Reference Part Shown: 4PX655

### **4PX655 (-6005)**

Four-Port Cross Style Manifold with 600 Series Barb, 1/4" (6.4 mm) Tubing ID

### **4PX680 (-6005)**

Four-Port Cross Style Manifold with 600 Series Barb, 1/2" (12.7 mm) Tubing ID

### **4PX670 (-6005)**

Four-Port Cross Style Manifold with 600 Series Barb, 3/8" (9.5 mm) Tubing ID

## Press-In Plugs



Reference Part Shown: PIP090

### **PIP60 (-1 -2 -6005 -J1A)**

Press-In Plug with Classic Series Barb, 1/4" (6.4 mm) Tubing ID

### **PIP680 (-6005)**

Press-In Plug with 600 Series Barb, 1/2" (12.7 mm) Tubing ID

### **PIP070 (-0 -6005)**

Press-In Plug with 500 Series Barb, 3/8" (9.5 mm) Tubing ID

### **PIP090 (-6005)**

Press-In Plug with 500 Series Barb, 5/8" (16.0 mm) Tubing ID

### **PIP670 (-6005)**

Press-In Plug with 600 Series Barb, 3/8" (9.5 mm) Tubing ID

### **PIP6100 (-6005)**

Press-In Plug with 600 Series Barb, 3/4" (19.0 mm) Tubing ID

### **PIP080 (-6005)**

Press-In Plug with 500 Series Barb, 1/2" (12.7 mm) Tubing ID

### **PIP6110 (-6005)**

Press-In Plug with 600 Series Barb, 1" (25.4 mm) Tubing ID

# LUER

## Fittings

Nordson MEDICAL's luer tapers are made to the ISO 594-1 and ISO 594-2 standards, and may be connected to other luers meeting these ISO standards. Please test your application to verify the performance of the interconnection. Nordson MEDICAL's luer fittings come in over 100 configurations and several materials for the device designer, joining tubing from 1/16" (1.6 mm) ID to 1/4" (6.4 mm) ID.

Due to space considerations, we only show a subset of our luer product family. To see the full line, please visit [www.nordsonmedical.com](http://www.nordsonmedical.com).



**MLRL055 (-1 -6005 -9)**  
Male Luer to 500 Series Barb, 1/4" (6.4 mm) Tubing ID  
(May be used with separate rotating lock ring: FSLLR)



**MLSL055 (-1 -6005 -9)**  
Male Luer to 500 Series Barb, 1/4" (6.4 mm) Tubing ID  
(May be used with separate stationary lock ring: FSLLR)



**MSL055 (-1 -6005 -9 -9002)**  
Male Luer to 500 Series Barb, 1/4" (6.4 mm) Tubing ID



**MTLL055 (-1 -2 -3 -4 -06 -6005 -07 -9 -9002)**  
Male Luer Integral Lock Ring to 500 Series Barb,  
1/4" (6.4 mm) Tubing ID



**MTLL360 (-1 -2 -6005 -6012 -9 -9002 -J1A)**  
Male Luer Integral Lock Ring to 300 Series Barb,  
1/4" (6.4 mm) Tubing ID



**FSLLR (-1 -2 -3 -4 -5 -06 -6005 -6012 -07 -9 -9002)**  
Finger Snap Luer Lock Ring



**FTLL055 (-1 -2 -3 -4 -5 -06 -6005 -07 -9 -9002)**  
Female Luer Thread Style to 500 Series Barb,  
1/4" (6.4 mm) Tubing ID



**FTLL360 (-1 -3 -5 -6005 -6012 -9 -9002 -J1A)**  
Female Luer Thread Style to 300 Series Barb,  
1/4" (6.4 mm) Tubing ID



## Features & Benefits:

- Published ISO design standard
  - Well understood worldwide
  - Often assures interconnections without the need to retrofit
- Rotating lock permits tube positioning prior to tightening
  - Minimizes twisting & kinking of tubing
- Tapered cone seal
- Available In several materials & configurations
- Inexpensive & easy to use

## Specifications:

### Tubing Sizes:

- 1/16" (1.6 mm) to 1/4" (6.4 mm)

### Standards Compliant:

- ISO 594-1 and ISO 594-2 standards

## It's a Lock with Nordson MEDICAL!

Our MLRL and MLSL Series of fittings can be used both as a slip luer or as a locking luer with the addition of our FSLLR luer lock ring, which allows color coding without flow path contact. Our MLSL/FSLLR combination results in a stationary lock ring. Use a combination of MLRL and FSLLR to create a color coded rotating lock ring.



## Looking for Something Different?

Most of our best product ideas have come from you, our customers. While we pride ourselves on our extensive product offering, we recognize that your needs are ever-changing and that our products, too, must adapt to your needs.

If there's a new product you think Nordson MEDICAL should make, please send us an email at [designcenter@nordsonmedical.com](mailto:designcenter@nordsonmedical.com) describing your product concept in as much detail as you desire. We will contact you with any questions, and who knows - the next catalog edition could include products YOU told us to build.

# NV Series

## Needlefree Swabable Valves

Nordson MEDICAL offers cost efficient needlefree swabable valves featuring higher flow rates, low priming volumes, and a straight through design for unobstructed flow. The valves don't require caps, and the septum surface can be easily disinfected. Designed for the injection and aspiration of fluids, particularly for sampling applications, the hermetic septum seal reduces the risk of biofilm formation and contamination. Available in widely used polycarbonate and copolyester materials, these valves are compatible with all industry standard luer syringes and connects, validating them as an efficient component solution for the OEM market.



### **NVFMLLCP**

Swabable Straight Valve, Female Luer to Male Luer Lock, Copolyester



### **NVFY401CP**

Swabable 'Y' Valve, Female Luer Y Port to 4.01 mm Tube Sockets, Copolyester



### **NVFBGPC**

Swabable Bag Valve, Female Luer to Bag Access Port, Polycarbonate



### **NVFMLLPC**

Swabable Straight Valve, Female Luer to Male Luer Lock, Polycarbonate



### **NVFY401PC**

Swabable 'Y' Valve, Female Luer Y Port to 4.01 mm Tube Sockets, Polycarbonate



### **NVFBV60PC**

Swabable Break-Off Valve, Female Luer to Break Off 6.0 mm Port, Polycarbonate



### **NVFY36PC**

Swabable 'Y' Valve, Female Luer Y Port to 3.6 mm Tube Sockets, Polycarbonate



### **NVFMLPC**

Bondable Valve, Female Luer to Male Luer Slip, Polycarbonate



### **NVFBV66PC**

Swabable Break-Off Valve, Female Luer to Break Off 6.6 mm Port, Polycarbonate

## Features & Benefits:

- Valve stems & bodies securely mate with all standard luer syringes & connectors
- Several configurations that are easy to customize
- Normally closed system to reduce the risk of infection
- Low priming volume & high flow rates
- Straight through design for unobstructed flow
- Gamma radiation stable & EtO compatible
- Not made with natural rubber latex or DEHP

## Non-Sterile Medical Device:

The NV Series products are shipped bulk, non-sterile and are single use components requiring further processing (e.g. assembly, packaging, sterilization) before clinical use. The buyer is responsible for determining effects of processing/multiple usage on these components, appropriateness of the component in the final application, and pre/post shelf life.



### **NVF20PC**

Tube End Valve, Female Luer to 2.0 mm Tube Socket, Polycarbonate



### **NVF37PC**

Tube End Valve, Female Luer to 3.7 mm Tube Socket, Polycarbonate



### **NVF20VPC**

20 mm Swabable Vial Cap, Female Luer to 20 mm Vial Cap, Polycarbonate



### **NVF25PC**

Tube End Valve, Female Luer to 2.5 mm Tube Socket, Polycarbonate



### **NVF41PC**

Tube End Valve, Female Luer to 4.1 mm Tube Socket, Polycarbonate



### **NVF13VPC**

Swabable T-Port Valve, Female Luer T-Port to 6.6 mm Tube Sockets, Polycarbonate



### **NVF28PC**

Tube End Valve, Female Luer to 2.8 mm Tube Socket, Polycarbonate



### **NVF13VPC**

13 mm Swabable Vial Cap, Female Luer to 13 mm Vial Cap, Polycarbonate

# SCV Series

## Single Check Valves

SCV Series check valves control directional flow to help prevent backflow. Products are available in several configurations, materials, and end fittings. The valves feature low priming volume, ease of removing air bubbles during priming and operate in any spatial orientation. All products feature DEHP- and latex-free silicone diaphragms and all materials of construction satisfy USP Class VI and ISO 10993 criteria. SCV Series products are offered in three different materials, MABS, SAN and polycarbonate, all featuring a patented silicone diaphragm. Several different end fittings are available, including tubing pockets, tubing sockets and male and female luer fitting ends.



### SCV06252

Check Valve, Female Locking Luer to Male Locking Luer, Clear Transparent SAN and Blue Transparent SAN with Silicone Diaphragm

Cracking Pressure: 2.9 +/- 0.725 psig  
Max. Back Pressure: 304.5 psig  
Flow Rate with Glucose:  $\geq$  150 ml/min



### SCV23050

Check Valve, Female Locking Luer to Male Locking Luer, Clear SAN with Silicone Diaphragm

Cracking Pressure:  $\leq$  .174 psig  
Max. Back Pressure: 87.023 psig  
Flow Rate:  $\geq$  90 ml/min

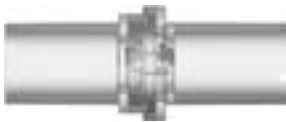

### SCV06352

High Flow Check Valve, Pocket for .346" (8.8 mm negative) OD Tubing to Pocket for .346" (8.8 mm negative) OD Tubing, Clear MABS with Silicone Diaphragm

Cracking Pressure:  $\leq$  .290 psig  
Max. Back Pressure: 14.500 psig  
Flow Rate:  $\geq$  1000 ml/min



### VPS5401068N

Check Valve, Male/Female Luer, 1/4 psi Inlet Cracking Pressure, Polycarbonate with Silicone Disc

Max. Back Pressure: 30 psig  
Flow Rate: 420 ml/min at 1 M head



### VPS4501036SN

Reflux Check Valve, Male/Female Luer, opens at 284 mmHg, Polycarbonate with Silicone Disc

Max. Back Pressure: 45 psig  
Flow Rate: 350 ml/min at 1 M head

# DCV Series

## Double Check Valves

Nordson MEDICAL's unique DCV Series bi-directional double check valve is designed to transfer clean fluid from a supply vessel to a use site. The fluid supply vessel is connected to the valve supply port (chimney) using a luer connection or tubing. The fluid is withdrawn from the supply vessel by a syringe or other device connected to the aspiration port. When the syringe is compressed the fluid is then transferred, through the exit port, to the use site without adulterating the fluid. DCV Series bi-directional valves are produced in polycarbonate resin using a silicone diaphragm, with two available inlet ports connecting to the female luer aspiration and male luer discharge ports.



### DCV115

Double Check Valve, Tubing Pocket Chimney Port, Rotating Luer Lock Exit Port, Radiation-Stable Polycarbonate with Biomed Grade Silicone Diaphragm, Cracking Pressure: 2-5 psi



### DCV125

Double Check Valve, Female Luer Chimney Port, Rotating Luer Lock Exit Port, Radiation-Stable Polycarbonate with Biomed Grade Silicone Diaphragm, Cracking Pressure: 2-5 psi

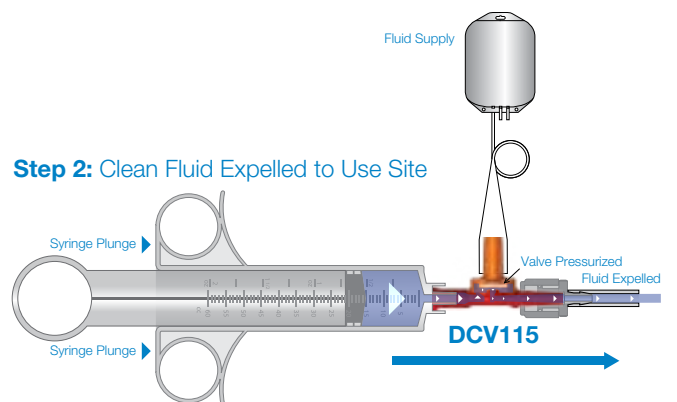
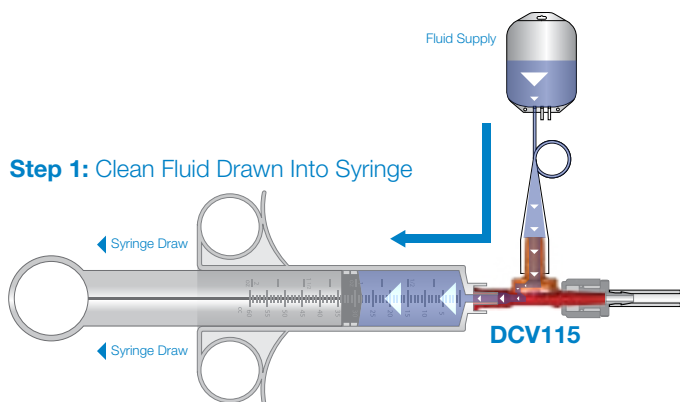

# SCV Series

## Barbed Check Valves

SCV Series barbed check valves were developed to provide a reliable mechanical connection and simplify tubing assemblies that often require multiple parts needed for in-line check valves. The valves feature 3/32" (2.4 mm) and 1/8" (3.2 mm) single barb ends in barb to barb straight through, reducing, and barb to male/female luer configurations. Barbed check valves reduce the risk of contamination and feature more precise, lower crack pressures and higher flow rates. They are ideal for medical device designers focused on bioprocessing, infusion, drainage and irrigation applications.



### SCV67220

Check Valve, 200 Series Barbs, 3/32" (2.4 mm) ID Tubing x 3/32" (2.4 mm) ID Tubing, White and Clear MABS with Silicone Diaphragm

Cracking Pressure:  $\leq .087$  psig  
Max. Back Pressure: 116.030 psig  
Flow Rate:  $\geq 150$  ml/min



### SCV67FL/220

Check Valve, 200 Series Barb, 3/32" (2.4 mm) ID Tubing x Female Luer Thread Style, White SAN and Clear MABS with Silicone Diaphragm

Cracking Pressure:  $\leq .087$  psig  
Max. Back Pressure: 116.030 psig  
Flow Rate:  $\geq 150$  ml/min



### SCV67220/230

Check Valve, 200 Series Barbs, 3/32" (2.4 mm) ID Tubing x 1/8" (3.2 mm) ID Tubing, White and Clear MABS with Silicone Diaphragm

Cracking Pressure:  $\leq .087$  psig  
Max. Back Pressure: 116.030 psig  
Flow Rate:  $\geq 150$  ml/min



### SCV67220/ML

Check Valve, Male Locking Luer x 200 Series Barb, 3/32" (2.4 mm) ID Tubing, White SAN and Clear MABS with Silicone Diaphragm

Cracking Pressure:  $\leq .087$  psig  
Max. Back Pressure: 116.030 psig  
Flow Rate:  $\geq 150$  ml/min

## Features & Benefits:

- Materials meet USP Class VI and ISO 10993 criteria
- DEHP- and latex-free silicone diaphragms
- All products are suitable for EtO or gamma sterilization
- Several connection configurations and materials
- Air bubbles completely removable during priming
- Operate in any spatial orientation

## Specifications:

### Materials:

- Housing - MABS and SAN
- Diaphragm - Latex-Free Silicone

### Cracking Pressure:

- $\leq 6$  mBar ( $\leq .087$  psig)

### Max. Back Pressure:

- 8 Bar (116.030 psig)

### Flow Rate (Water):

- $\geq 150$  ml/min ( $\geq .0396$  gal/min)



### SCV67230

Check Valve, 200 Series Barbs, 1/8" (3.2 mm) ID Tubing x 1/8" (3.2 mm) ID Tubing, White and Clear MABS with Silicone Diaphragm

Cracking Pressure:  $\leq .087$  psig  
Max. Back Pressure: 116.030 psig  
Flow Rate:  $\geq 150$  ml/min



### SCV67FL/230

Check Valve, 200 Series Barb, 1/8" (3.2 mm) ID Tubing x Female Luer Thread Style, White SAN and Clear MABS with Silicone Diaphragm

Cracking Pressure:  $\leq .087$  psig  
Max. Back Pressure: 116.030 psig  
Flow Rate:  $\geq 150$  ml/min



### SCV67230/220

Check Valve, Barb for 1/8" (3.2 mm) x 3/32" (2.4 mm) ID Tubing, White and Clear MABS with Silicone Diaphragm

Cracking Pressure:  $\leq .087$  psig  
Max. Back Pressure: 116.030 psig  
Flow Rate:  $\geq 150$  ml/min



### SCV67230/ML

Check Valve, Male Locking Luer x 200 Series Barb, 1/8" (3.2 mm) ID Tubing, White SAN and Clear MABS with Silicone Diaphragm

Cracking Pressure:  $\leq .087$  psig  
Max. Back Pressure: 116.030 psig  
Flow Rate:  $\geq 150$  ml/min

# FC Series

## Stopcocks

Nordson MEDICAL's stopcocks are designed to easily control the flow of a liquid or gas through the use of an on/off diverter, and are available in three basic configurations – 1-way, 3-way, and 4-way. These chemically resistant stopcocks are available as standard or high flow and are offered in polycarbonate, PEI and nylon with HDPE diverters.

FC Series stopcocks bring efficiency, convenience, and practicality to your tubing applications and are 510(k) cleared. Nordson MEDICAL also offers custom solutions, including manifolds, ganged manifolds, and tubing assemblies.



**FCFM-001**  
Stopcock, 1-way, Female Luer to Male Luer, Clear Polycarbonate Body, 2 Arrow Natural HDPE Diverter



**FCFMR-001**  
Stopcock (Non-Sterile), 1-way, Female Luer to Male Luer with Luer Lock Ring, Polycarbonate

## Stopcock Configurations

### 1-Way Stopcocks

1

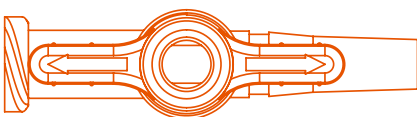

### 3-Way Stopcocks

1 2 3

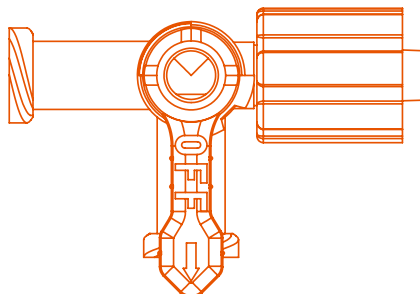

### 4-Way Stopcocks

1 2 3 4

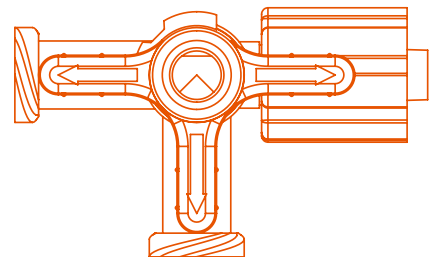



## Features & Benefits:

- Multiple configurations:  
1-way, 3-way, 4-way
- Chemically resistant
- 510(k) cleared
- Not made with DEHP
- Diverter arrows that provide a clear indication of flow
- Custom solutions available, including manifolds, ganged manifolds, and tubing assemblies

## Specifications:

### Flow Options:

- Standard flow
- High flow

### Materials:

- Polycarbonate
- PEI
- Nylon
- HDPE



### FCHPFFMR-001

Stopcock, 3-way, Female Luer to Female Luer to Male Luer with Luer Lock Ring, High Pressure, Clear Polycarbonate Body, 4 arrow Gold Acetal Diverter, Clear Polycarbonate Lock Ring



### FCLBFFMR-1A-003

Stopcock, 3-way, Female Luer to Female Luer to Male Luer with Luer Lock Ring, Large Bore



### FCLBFFM-1A-003

Stopcock, 3-Way, Large Bore, Female Luer to Female Luer to Male Luer, Polycarbonate Body, 1 Arrow Natural HDPE Diverter



### FCFFMR-003

Stopcock, 3-way, Female Luer to Female Luer to Male Luer with Luer Lock Ring

## Need More Details?

Part drawings, minimum order quantities, and CAD requests can be found online at [www.nordsonmedical.com](http://www.nordsonmedical.com).

# SILICONE

## Tubing

### 50 Shore A

Our silicone tubing is extruded from a low-volatile grade, platinum-cured compound that is ideal for critical applications in pharmaceutical, biotech, medical, food, and beverage industries.

### Part Drawings Online!

Nordson MEDICAL provides dimensional drawings available for download for all of its fittings.  
[www.nordsonmedical.com](http://www.nordsonmedical.com)

### Technical Assistance

Trying to choose the correct part? Need more material information than is published in this catalog? Call Nordson MEDICAL Technical Support at (970) 267-5200.

### Resin Grade & Technical Information:

This tubing is extruded and packaged in a Class 7 (Class 10,000) ISO-certified clean room. It has undergone extensive physical, chemical, and biological testing and meets USP Class VI, FDA CFR 177.2600, ISO 10993, European Pharmacopoeia 3.1.9, and 3-A standards. It is certified free of animal-derived ingredients and is certified by the National Sanitation Foundation for use in food equipment materials (NSF-51). It offers a temperature range use of -100°F (-73.3°C) to 400°F (204.4°C) and is sterilizable by autoclave or gamma irradiation.



#### Dimensions (ID X OD X LGTH)

<b>SILC7001098</b>	1/16" X 1/8" X 50'
<b>SILC7001657</b>	1/8" X 1/4" X 50'
<b>SILC7002203</b>	1/4" X 3/8" X 50'
<b>SILC7002593</b>	3/8" X 5/8" X 50'
<b>SILC7002775</b>	1/2" X 3/4" X 50'
<b>SILC7003139</b>	3/4" X 1" X 50'

# TPE

## Tubing

### 65 Shore A

Our Biopharmaceutical-grade thermoplastic elastomer (TPE) tubing is sterile weldable, heat sealable, moldable, and offers excellent life in peristaltic pumps. It is ideal for use in single-use processes for sampling, filling, and storage tubing set assemblies.

#### Resin Grade & Technical Information:

This tubing is made from FDA-approved ingredients, certified free of silicone oils and animal derived ingredients, and is sterilizable by autoclave or gamma irradiation. It meets various ISO and USP standards, including Class VI, as well as European Pharmacopoeia 3.2.2.1. It also offers excellent low absorption and permeability as compared to silicone tubing.



#### Dimensions (ID X OD X LGTH)

<b>AF7500077</b>	1/8" X 1/4" X 50'
<b>AF7500155</b>	3/16" X 5/16" X 50'
<b>AF7500311</b>	1/4" X 7/16" X 50'
<b>AF7500506</b>	3/8" X 5/8" X 50'
<b>AF7500584</b>	1/2" X 3/4" X 50'
<b>AF7500753</b>	3/4" X 1" X 50'

#### Custom Assembly

We produce standard components to fit your current assemblies and devices, but we also provide custom solutions by applying a variety of assembly options, such as joining fittings, connectors, filters, and other components to tubing. From systems using a single fitting to complex configurations utilizing various components, we can design complete assemblies to your requirements.

# INDEX

Nordson MEDICAL prides itself in developing original designs and custom solutions. All products can be customized to meet your specific user requirements, as our experienced engineering and service teams understand today's medical device markets. We are dedicated to exceeding your expectations.

4PX655 .....	31	G424TRX-0200 .....	17
4PX670 .....	31	G424TRX-0300 .....	17
4PX680 .....	31	Gaskets .....	16
3060.....	24	GM4749TRX-0600 .....	17
4060.....	24	GMN450 .....	16
5060.....	24	GMX455.....	16
6060.....	22	L60.....	26
AF7500077 .....	43	L070.....	26
AF7500155 .....	43	L070/055 .....	27
AF7500311 .....	43	L080.....	26
AF7500506 .....	43	L080/070 .....	27
AF7500584 .....	43	L090.....	26
AF7500753 .....	43	L100.....	26
Bag Ports .....	18	L100/080 .....	27
Barbed Check Valves .....	38	L110.....	26
BioClamp® .....	10	L110/100 .....	27
BioValve®.....	11	L970.....	26
CF494 .....	26	L975.....	26
CPAN75 .....	6, 7	L6110.....	26
CPAX150.....	6, 7	Luer Fittings.....	32
CPN75 .....	8, 9	Maxi Flange .....	13
CPT100.....	9	Mini Flange .....	12
CPX150.....	8, 9	MLRL055 .....	32
DCV115 .....	37	MLSL055 .....	32
DCV125 .....	37	MSL055 .....	32
Double Check Valves.....	37	MTLL055.....	32
Easy-Open Clamps .....	6	MTLL360.....	32
Elbow Fittings .....	26	Multiport Fittings .....	31
Elbow Reducer Fittings.....	27	N055 .....	22
FCFFMR-003 .....	41	N055/013.....	24
FCFM-001.....	40	N055/025 .....	24
FCFMR-001 .....	40	N055/035.....	24
FCHPFFMR-001 .....	41	N065 .....	22
FCLBFFM-1A-003.....	41	N065/025.....	24
FCLBFFMR-1A-003.....	41	N065/035.....	24
FSLLR .....	32	N065/055.....	24
FTLL055.....	32	N070 .....	22
FTLL360.....	32	N070/013.....	24
G40MPGR-TF150 .....	16	N070/055.....	24
G42MPGR-TF075 .....	16	N080 .....	22

## Custom Product Development & Design:

- Modular designs that allow for easy customization
- Concept & prototype development capabilities
- Research & development labs
- DFM part design
- CAD files - SolidWorks & FEA
- Solid modeling
- Use of Computational Fluid Dynamics (CFD) software
- 3-D printing & rapid prototyping
- Bench testing
- Verification & validation testing including sterilization, packaging, shelf life, and biocompatibility process validation
- Assembly & packaging
- Private labeling options

N080/055.....	24	NVfy36PC.....	34
N080/070.....	24	NVfy401CP.....	34
N090.....	23	NVfy401PC.....	34
N090/055.....	25	Opposing Barb Ports.....	20
N090/070.....	25	PharmaLok™ Clamps.....	6
N100.....	23	PIP60.....	31
N100/080.....	25	PIP070.....	31
N110.....	23	PIP080.....	31
N110/100.....	25	PIP090.....	31
N670.....	22	PIP670.....	31
N670/655.....	24	PIP680.....	31
N680.....	22	PIP6100.....	31
N680/655.....	24	PIP6110.....	31
N680/670.....	25	Press-In Plugs.....	31
N690.....	23	RQCF655.....	4
N690/655.....	25	RQCF670.....	4
N690/670.....	25	RQCFC.....	4
N970.....	22	RQCFL655.....	4
N975.....	22	RQCFL670.....	4
N6100.....	23	RQCFLC.....	4
N6100/670.....	25	RQCM655.....	4
N6100/680.....	25	RQCM670.....	4
N6110.....	23	RQCMP.....	4
N6110/680.....	25	RQ Series Quick Connects.....	4
N6110/6100.....	25	RQXF670.....	5
Needlefree Swabable Valves.....	34	RQXF680.....	5
NVf13VPC.....	35	RQXFC.....	5
NVf20PC.....	35	RQXFL670.....	5
NVf20VPC.....	35	RQXFL680.....	5
NVf25PC.....	35	RQXFLC.....	5
NVf28PC.....	35	RQXM670.....	5
NVf37PC.....	35	RQXM680.....	5
NVf41PC.....	35	RQXMP.....	5
NVFBGPC.....	34	SCV67FL/220.....	38
NVFBV60PC.....	34	SCV67FL/230.....	39
NVFBV66PC.....	34	SCV06252.....	36
NVFMLLCP.....	34	SCV06352.....	36
NVFMLLPC.....	34	SCV23050.....	36
NVFM LPC.....	34	SCV67220.....	38
NVFTPC.....	35	SCV67220/230.....	38

# INDEX

Nordson MEDICAL maintains a comprehensive list of all material and regulatory information, enabling you to select the most appropriate products for your particular application. With a solid reputation for quality, service and reliability, Nordson MEDICAL can provide the detailed support you need from idea to market. Our global regulatory and registration expertise is at your service.

SCV67220/ML .....	38	Single-Use Clamps .....	8
SCV67230 .....	39	Stopcocks .....	40
SCV67230/220 .....	39	Straight Through Fittings .....	22
SCV67230/ML .....	39	Straight Through Reducer Fittings .....	24
SFBP630 .....	18	T055 .....	28
SFBP635/635 .....	20	T60 .....	28
SFBP655 .....	18	T070 .....	28
SFBP655/655 .....	20	T070/055 .....	29
SFBP670 .....	18	T080 .....	28
SFBP670/670 .....	20	T080/055 .....	29
SFBP680 .....	18	T080/070 .....	29
SFBP680/680 .....	21	T100 .....	28
SFBP6100 .....	18	T100/080 .....	29
SFBP6100/6100 .....	21	T110 .....	28
SFBP6110 .....	18	T110/100 .....	29
SFBPF1 .....	19	T360/220 .....	29
SFBPF3 .....	19	T360/230 .....	29
SFMN655 .....	12	T360/250 .....	29
SFMN670 .....	12	T670 .....	28
SFMN680 .....	12	T680 .....	28
SFMN6100 .....	12	T690 .....	28
SFMNC .....	12	T970 .....	28
SFMX655 .....	13	T975 .....	28
SFMX670 .....	13	T6100 .....	28
SFMX680 .....	13	T6110 .....	28
SFMX6100 .....	13	Tee Fittings .....	28
SFMX6110 .....	13	Tee Reducer Fittings .....	29
SFMXC .....	13	TPE Tubing .....	43
SFMXT680 .....	15	Tube Clamps .....	9
SFMXT6110 .....	15	Tube-to-Tube Fittings .....	22
SF Series Instrument Tees .....	14	VBV0500NW .....	11
SF Series Sanitary Fittings .....	12	VBV1000NW .....	11
SILC7001098 .....	42	VNG075WHT .....	10
SILC7001657 .....	42	VNG150WHT .....	10
SILC7002203 .....	42	VNG200WHT .....	10
SILC7002593 .....	42	VNG250WHT .....	10
SILC7002775 .....	42	VNG300WHT .....	10
SILC7003139 .....	42	VNG400WHT .....	10
Silicone Tubing .....	42	VNG600WH .....	10
Single Check Valves .....	36	VNG800WH .....	10

Contact us to learn more about our bioprocessing capabilities.

TEL: +1 (970) 267-5200

TOLL FREE in USA: (888) 404-5837

[www.bioprocesscomponents.com](http://www.bioprocesscomponents.com)

[www.nordsonmedical.com](http://www.nordsonmedical.com)



VPS4501036SN .....	36
VPS5401068N .....	36
Y055 .....	30
Y070 .....	30
Y080 .....	30
Y090 .....	30
Y100 .....	30
Y110 .....	30
Y260 .....	30
Y460 .....	30
Y670 .....	30
Y680 .....	30
Y690 .....	30
Y6100 .....	30
Y6110 .....	30
Y Fittings .....	30

---

©Nordson MEDICAL. All rights reserved. **MAR-BIOP-BR Rev. B** 2015-10

Value Plastics, Inc.  
dba Nordson MEDICAL  
805 West 71st Street  
Loveland, CO 80538, USA

**Phone:** (970) 267-5200  
**Toll Free:** (888) 404-5837

[sales@nordsonmedical.com](mailto:sales@nordsonmedical.com)  
[www.nordsonmedical.com](http://www.nordsonmedical.com)

Asia Pacific  
Flat/RM 710, Topsail Plaza  
No. 11 On Sum Street  
Siu Lek Yuen, Shatin, N.T., Hong Kong

**Phone:** +011 (852) 6808-9862  
**Toll Free:** +011 (852) 2470-9802

[cnsales@nordsonmedical.com](mailto:cnsales@nordsonmedical.com)  
[www.nordsonmedical.com](http://www.nordsonmedical.com)



European Service Center

**Phone:** +31 43 750 1523  
**Toll Free:** 00800 7001 7001

[esc-key-customer@nordson.com](mailto:esc-key-customer@nordson.com)  
[www.nordsonmedical.com](http://www.nordsonmedical.com)